

Soils Map

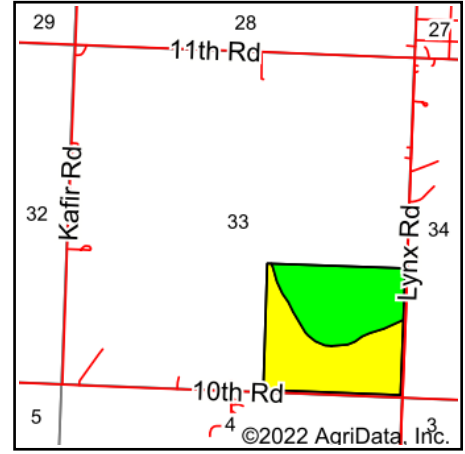
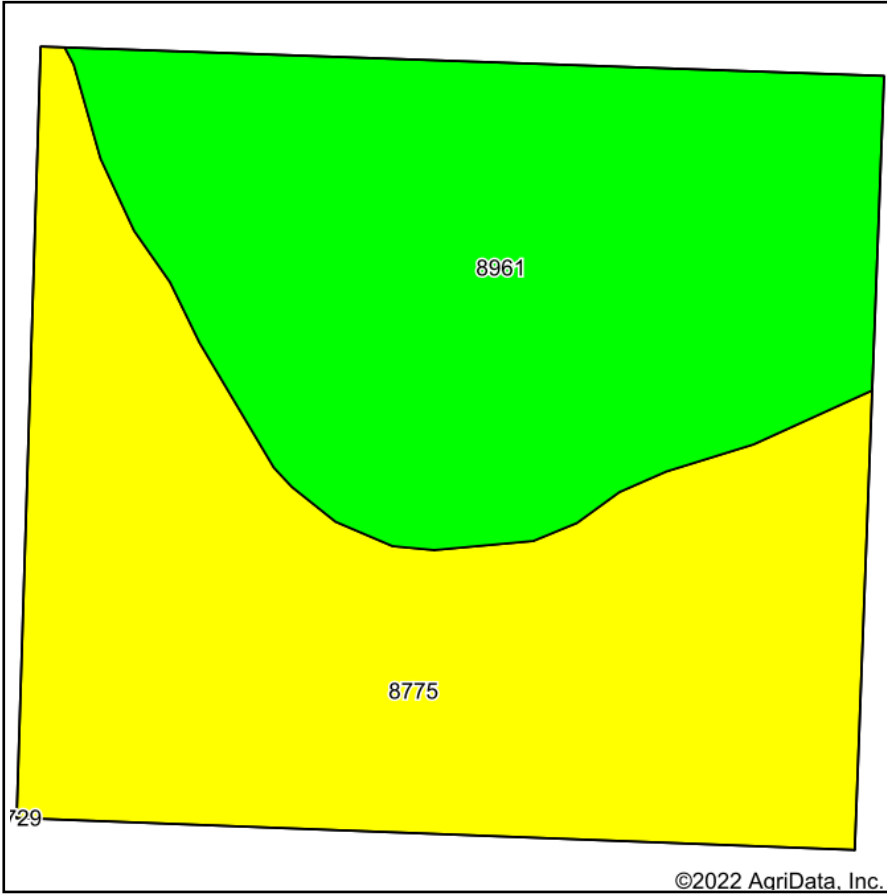

State: **Kansas**
 County: **Coffey**
 Location: **33-21S-15E**
 Township: **Burlington**
 Acres: **96.94**
 Date: **7/19/2022**

Maps Provided By:

 CUSTOMIZED ONLINE MAPPING
 © AgriData, Inc. 2021 www.AgriDataInc.com



Soils data provided by USDA and NRCS.

Area Symbol: KS031, Soil Area Version: 19

Code	Soil Description	Acres	Percent of field	Non-Irr Class Legend	Non-Irr Class *c
8775	Kenoma silt loam, 1 to 3 percent slopes	51.40	53.0%		IIIe
8961	Woodson silt loam, 0 to 1 percent slopes	45.54	47.0%		IIIs
Weighted Average					2.53

*c: Using Capabilities Class Dominant Condition Aggregation Method
 Soils data provided by USDA and NRCS.